

North

To reach our discipleship class attendance goal from 1/3 to 2/3rds of our church role, we need more accessible classrooms for a class size of 10-15 students per class.

Closing in breezeway for classrooms and new 120'x 120' multi-use area with 60 x 100' concrete slab.

Approximately \$350,000

Breezeway  
50' x 120'

Fenced 120x120' Multi-use Area

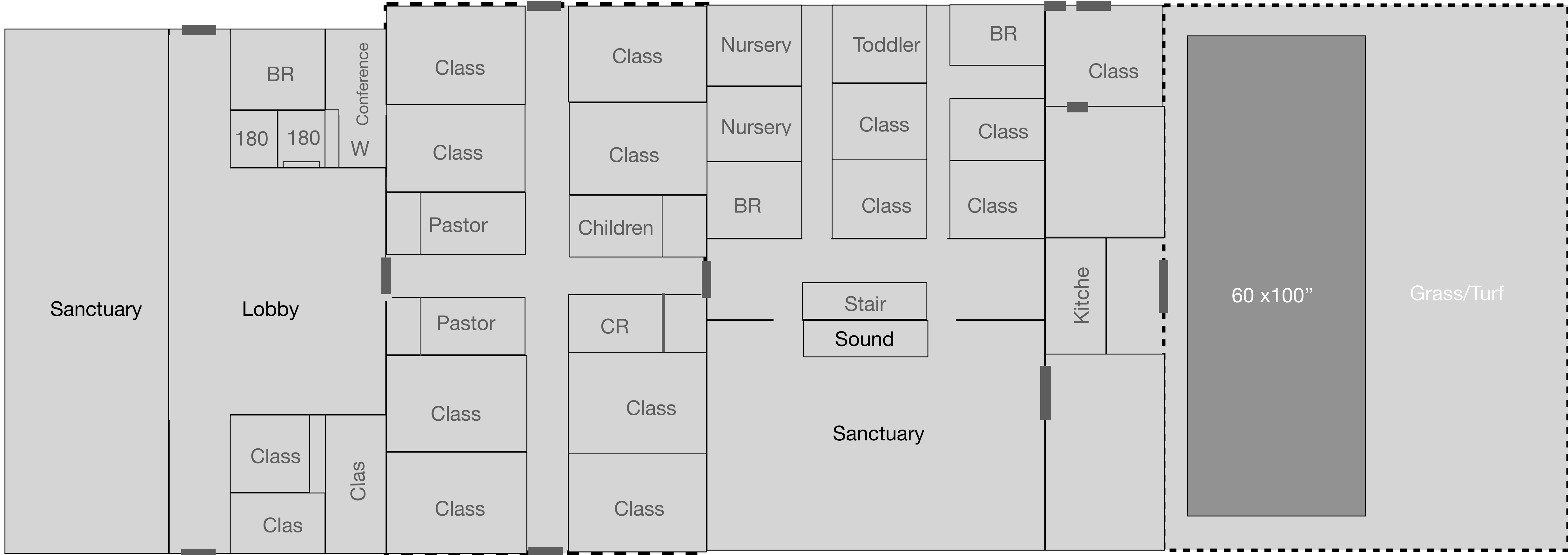

All adult classes will be in the breezeway.

N

120'x120'  
Fenced  
\$12K

