



FORWARD

A NEW DAY IS COMING



Westminster Church
75
CELEBRATING
75 YEARS



TABLE OF CONTENTS

Letter from Brent	4
Major moves forward	5
Forward goals	8

THE MISSION

Who we are now	11
Kids	13
Students	14
Adults	15
Missions	17
Community Impact	19

MULTIPLICATION

Building mockup	23
Building changes	25
Your giving journey	27
Sample commitment card	28
FAQ	29
Giving chart	30

SERMONS & STUDIES

Sermon notes	33
LifeGroup questions	43
Kids/Family guide	53
Student stuff	54





A NEW DAY IS COMING.

First MB has a pretty incredible history. This church family began over 75 years ago as a group of 19 people following a reluctant young pastor near downtown Wichita.

God has been so good to us over the years, and I regularly hear amazing stories of how God is at work in and through our congregation.

I think it's safe to say we have significantly more impact than our founders ever imagined possible.

But we're not done yet.

We believe God is leading us to a new day. We're excited about the potential of a new church name and a new building, but our vision for our church's future is so much bigger. As we embark on these exciting changes, we want to move forward together as a church family with prayer, risk, surrender, and joy.

We need all hands on deck, so I hope you choose to join with us together as we move forward!

Brent Warkentin

Brent Warkentin | Lead Pastor

MAJOR MOVES FORWARD

Throughout our church's history, God has been at work refining us, growing us, and giving new vision. We recently celebrated our 75th birthday, and we are grateful for the rich history we have.

Of course the church is—and always has been—about so much more than physical buildings. But looking back, it's easy to divide our story into distinct chapters defined by buildings.

1943



First Mennonite Brethren Church is born.

1959



Congregation moves to 17th & Gow.

1987



Congregation moves to West 21st Street.

1993



Kids and students wing added to the building.

2003



Launch of WSN/contemporary worship services.

2010



Construction begins on new Worship Center.



NEW DAY

WE BELIEVE GOD IS CALLING US FORWARD.

Pastor Brent's "New Day" sermon series last October was the first step into this new season. Along with this building project, we also talked about (and voted to approve) a change to our church name.

While these two things are big and certainly very public, the "new day" we're striving for is much bigger and much more important than these two things by themselves.

In this season, we want to be more intentional about reaching out to young adults and young families in our community. Many decisions we make in the coming years will be made through that filter.

We also want to be more intentional about listening to the Holy Spirit and His leading for our church family. This "culture of response" is something we want to continue to grow and foster.



Watch the New Day series at firstmbchurch.org/messages



TO HELP US REACH THIS NEW DAY,

WE'RE LAUNCHING THE FORWARD CAMPAIGN.

PRIMARY GOAL:

100% engagement by:

- >> Putting Christ first in your life
- >> Surrendering to God's movement in your life
- >> Trusting God fully for His provision

SECONDARY GOAL:

Trusting God to provide resources,
totaling \$9.6 million

- >> **\$5.1M** general ministry budget over the next two years to fund our **MISSION**
- >> **\$4.5M*** towards the expansion/renovation project to support our **MULTIPLICATION**

Total over two years: **\$9.6M**

* The building project has a total projected cost of \$7.5M, with the remaining \$3M debt being paid off as soon as possible.



Keep reading to learn about our Mission & Multiplication.

THE

MISS

SION

WHO WE ARE NOW

2019 BY THE NUMBERS

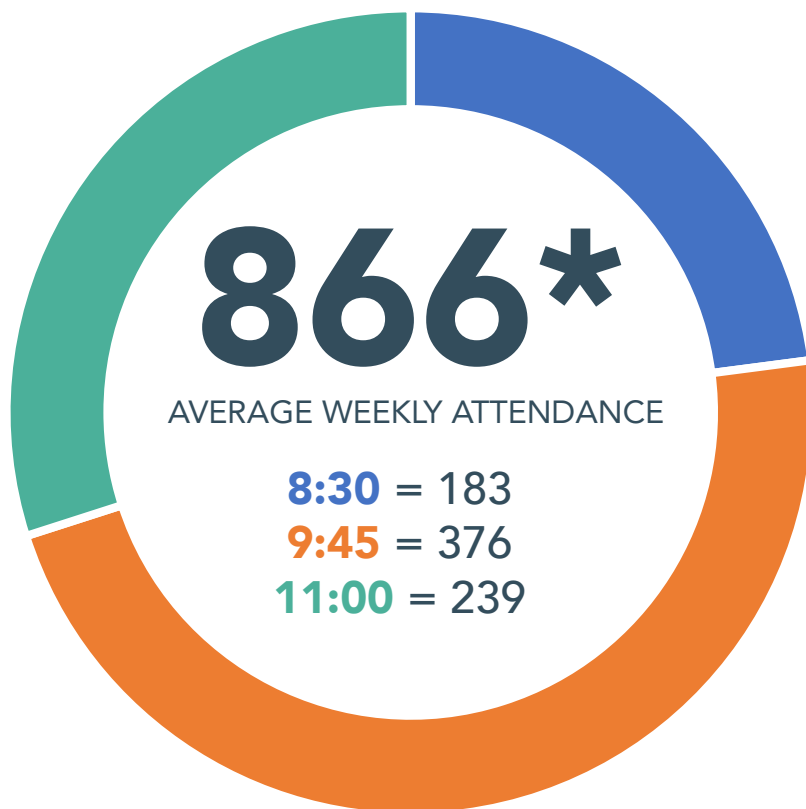

16 Baptisms!



**215 First-time
Guests**

** This does not include approximately 100 infants, kids, and students who attend weekly but do not participate in the worship service.*

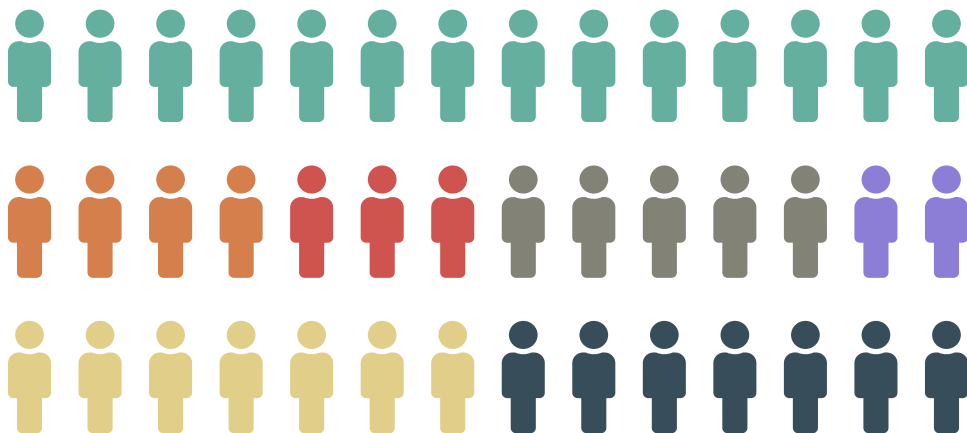

180 VOLUNTEERS EVERY WEEK!

60 IN KIDS MINISTRY | 18 IN SENIOR HIGH | 12 IN
JUNIOR HIGH | 10 IN TECH/WORSHIP | 30 IN CHOIR
29 USHERS/GREETERS | 21 ADULT CLASS LEADERS



YOU'RE VERY GENEROUS!

\$47,306

average weekly offering

\$148,455

surplus!

We finished the year under-budget,
but over our expenses.
Overall, that's great news!

\$113,461

Thanksgiving offering

our *BIGGEST*

BIG OFFERING

... ever!

Given in one week to support
Family Promise, MB missionaries, &
Karubabi Harvest School in Burundi



KIDS



95

Average attendance:
Activate
Wednesday nights

85

Average attendance:
Kids Worship
Sunday mornings

205

Attendance at
VBS



STUDENTS



79

Average attendance:
Axis (Senior High)
Sunday nights

54

Average attendance:
Amplify (Junior High)
Wednesday nights

113

Students went to camp
(Junior High and
Senior High)



ADULTS



162

Avg. attendance:
Sunday School

184

Avg. attendance:
LifeGroups

77

Men attended
Men's Encounter

320

Women attended
Fall Connection

DID YOU KNOW?

4,581

Worship services
streamed online (!)

42,234

Visits to our website

416

Downloads of our
new mobile app



YOUNG ADULTS

This year our **Converge** ministry for college students and young adults split into two new groups: **Converge Connect** for all 20s and 30s and **M:Life** for young married couples. Attendance has been growing and we're excited for these ministries that will play a crucial role in our goal of more effectively reaching young adults.

CONVERGE

CONVERGE
CONNECT.

M:Life

God loves the world

(and we do, too)

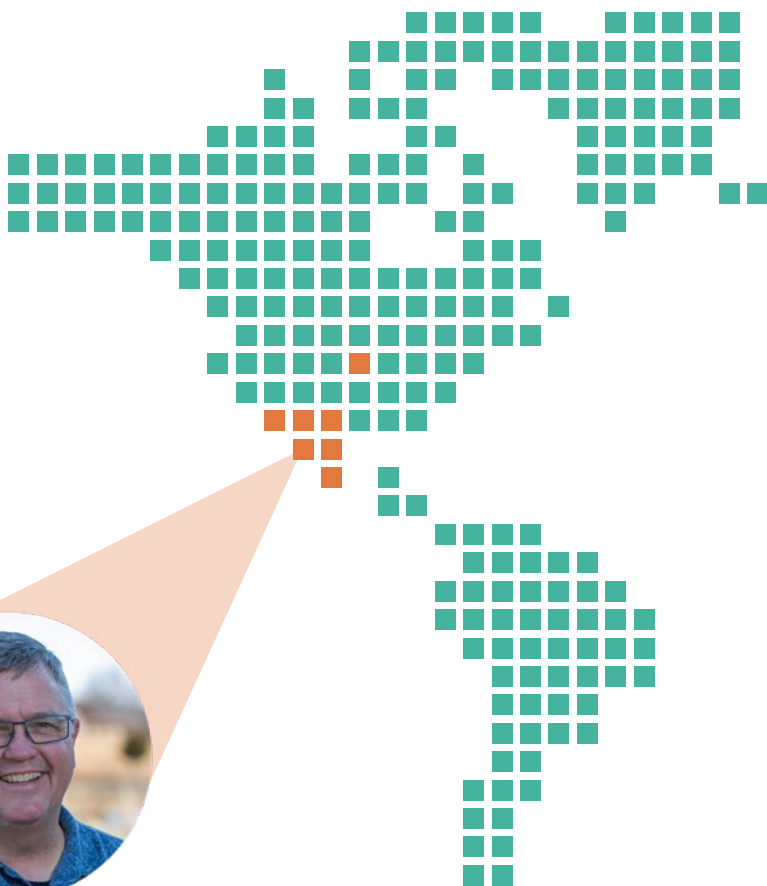

MEXICO

Greg Law is serving with Foundation For His Ministry in Baja, Mexico. He oversees short-term mission teams coming to serve-- including the teams from First MB every year!

PLUS!

These families serve in restricted access countries, so their names, photos, and locations are withheld for security reasons.

P & S
S & L

S & D
K & M

THAILAND & LAOS

Bob & Chris Davis and **Andy & Carmen Owen** serve the region in many ways. Their prison ministry saw **10** new believers last year, and **8** new house churches were started in December alone!



BURUNDI

Travis Jost is partnering with local leaders to support ministry efforts in local schools and villages. The Karubabi Harvest School serves **423** kids from **3** ethnic groups historically in conflict, but God is moving them toward peace!

God loves Wichita

(and we do, too)



Prison Ministry.

29 First MB ladies encourage women in prison through our pen pal program.



Family Promise.

In 2019 we hosted **12** homeless families in our facility with an average of **60** First MB volunteers.



Downtown Breakfasts.

Every fifth Sunday, **25** First MBers serve breakfast to the homeless in downtown Wichita.



Lighthouse.

This year our sister church in Oaklawn served **1,950** low-income families through the Giving Center.



After School Bible Clubs.

First MBers teach kids Bible stories in area public schools.

In 2019 **36** kids accepted Christ!



Youth Horizons.

Mentors spend time with at-risk youth to break the cycle of poverty. Currently we have **16** First MBers serving as mentors!



Enders Elementary.

Enders is a lower-income school with many opportunities to serve. This year we paid off **10** overdue lunch accounts!

These organizations allow us to make a real impact in our community... and we're always looking for help.

 Sign up to join us at firstmbchurch.org/wichita.

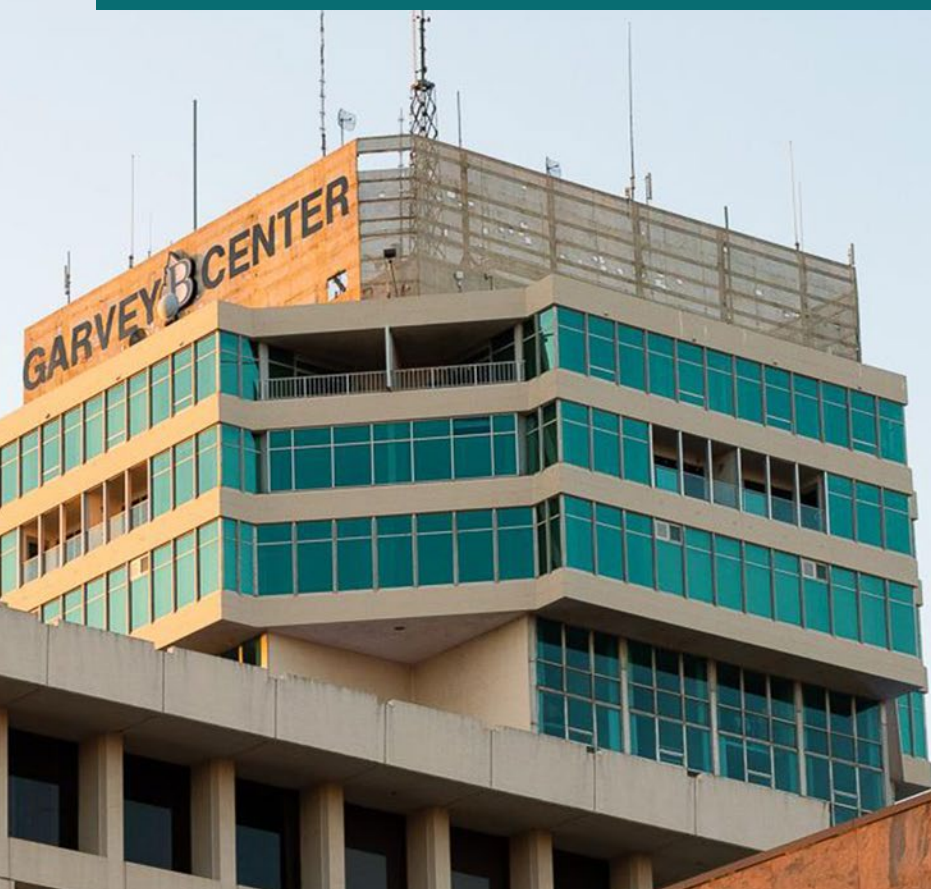

MULT
PLICATA

IX

ATION

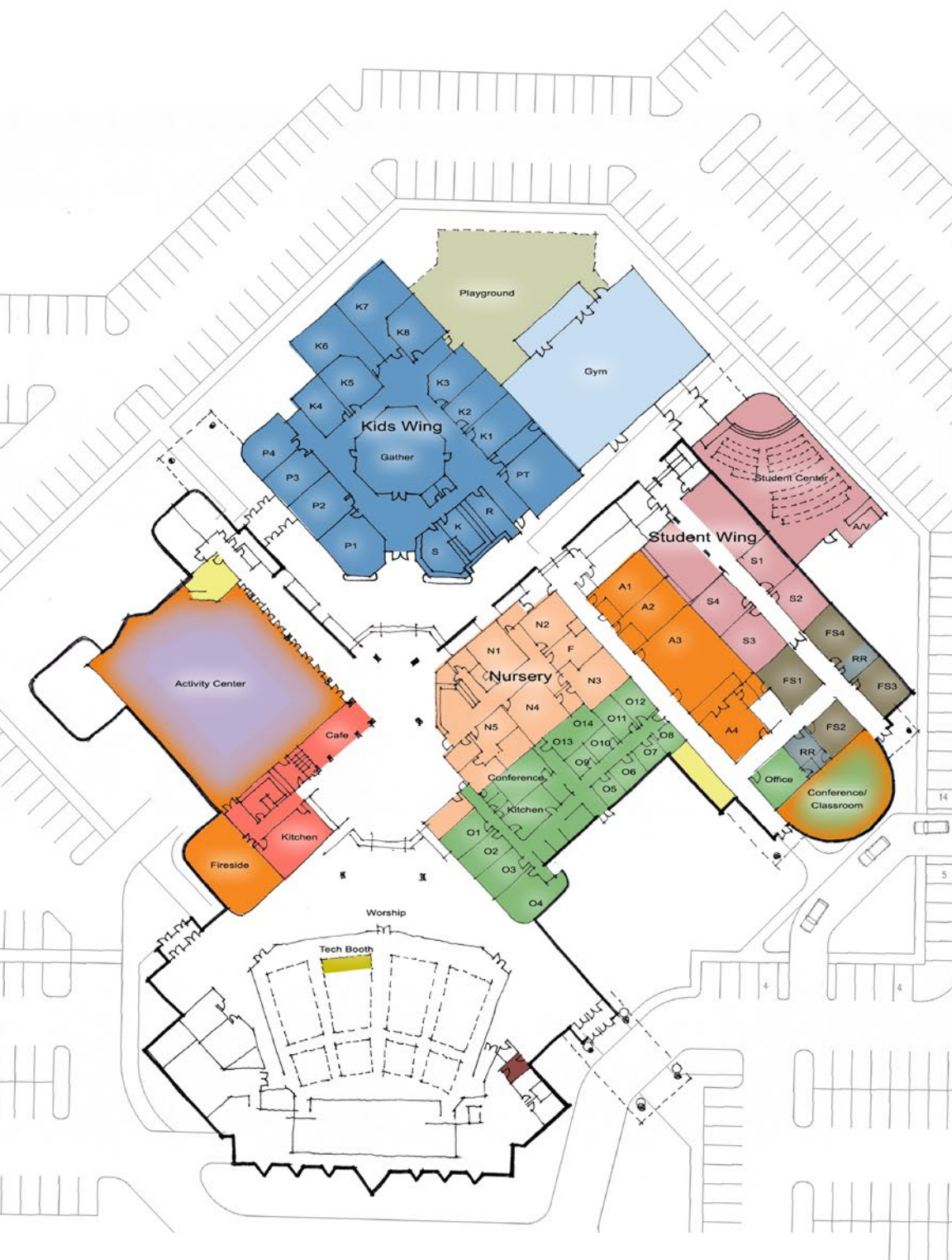

— The solid black line indicates the perimeter of our existing facility.

THE PLAN

This building project solves many of the issues causing problems for our ministries. Most notably:



NEW KIDS WING

Our current kids wing is hindering our ministry potential. This new space allows for growth, plus much-needed security updates and a more contemporary feel.



DEDICATED STUDENT SPACE

Our high school students don't currently have their own space. This project gives us a dedicated student wing, complete with a new gym space.



ADULT CLASSROOMS

On Sundays and Wednesdays, we don't have any open classrooms for additional LifeGroups, Sunday School classes, or special events to start meeting.



KITCHEN EXPANSION

Our kitchen gets a lot of use! This renovation includes repairs to appliances, more storage space, and a redesign to more effectively utilize the space.



OFFICE RENOVATION

Our staff offices are at capacity. We need space to allow for growth. Plus, our current offices are inconveniently spread throughout the entire building.



MAJOR PERKS



SECURITY.

The new single-entry to kids ministry will help eliminate risks.



ACCESSIBILITY.

Parents will be able to see the kids area easily from the lobby.



BETTER LAYOUT.

Our classrooms and offices will be closer and grouped together.



TLC.

Many rooms need updating and a more contemporary feel.



GROWTH.

On Sundays and Wednesdays, we're already at capacity!



MASTER PLAN.

Instead of temporary fixes, this fits into our long-term plan.



AVOID CONGESTION.

When foot traffic is at its peak in between services, the layout of our lobby creates unnecessary congestion with a narrow entryway. Opening this space will allow for much smoother flow.

YOUR GIVING JOURNEY



INITIAL GIVER 2 Corinthians 8:7-15

An Initial Giver is someone who decides to give for the first time out of a response to God's Word. This person decides to give and trust God and the leaders of the church with this gift.



CONSISTENT GIVER 2 Corinthians 9:6-8

A Consistent Giver decides to give and do it consistently to exercise the discipline of giving. This is often done online through automatic recurring gifts, but it doesn't have to be!



PRIORITY GIVER Luke 14:28-35

An Priority Giver places such a significant priority on their giving that it drives their spending and their saving, as opposed to their spending and saving driving their giving.



SURRENDERED GIVER Colossians 1:15-18, 22-23

A Surrendered Giver seeks to honor God with 100% of their resources. They give in a way that changes them, in a way that reflects that everything they have belongs to God.



ETERNAL GIVER 1 Timothy 6:6-19

An Eternal Giver makes decisions in the short term that have longer term effects on their generosity. They think of what home to buy, what car to purchase, and how much to save all in relation to their generosity capacity.

1 FUND

It's possible you've been a part of church campaigns in the past where you were asked to give "above and beyond" your regular giving. In fact, we've done that as part of our Harvest Project and Greater Things campaigns that allowed us to build our Worship Center a few years ago.

Since then, we've found that "over and above" giving is potentially confusing to people who don't have a baseline for their "normal giving." It also has the potential to diminish the significance of the ongoing generosity and current ministries making an impact at First MB.

The Forward campaign will last two years. In those two years, every gift given will go to the Forward campaign to help fund our **mission** (our general budget) and our **multiplication** (the building project).

Below you'll find a sample commitment card so you can see how a "one fund initiative" works. Please take the time to fill this out, but don't worry--you'll get a shiny new card on Commitment Sunday (March 1).

MOVING FORWARD

\$	<input type="text"/>	What I/we would normally give in one year
+\$	<input type="text"/>	My/Our expanded annual generosity as part of the Forward campaign
= \$	<input type="text"/>	x 2 years
		↓
		\$ <input type="text"/>
	Gifts from my/our stored resources (savings, stocks, property, possessions)	+\$ <input type="text"/>
MY/OUR TOTAL 2-YEAR COMMITMENT:		
\$	<input type="text"/>	
March 2020 - March 2022		

FAQ

WHAT ARE YOU ASKING ME TO DO?

First and foremost we are asking you to pray. Prepare your heart to hear Him, and then listen to what He says.

If you haven't already, join a small group during this season. Talk with your spouse or your family about what this commitment will mean for you. We are asking that you make a sacrificial commitment to move your faith FORWARD – whatever that means for you and your relationship with God. Follow His leading – nothing more, nothing less.

ARE THERE ADDITIONAL WAYS BESIDES CASH THAT I CAN GIVE TOWARDS THIS CAMPAIGN?

Absolutely. You might have stocks, property, or other items you feel called to give. We'd love to help you with that any way we can, so please contact Becky Klassen (our bookkeeper) at bklassen@firstmbchurch.org if you have questions about non-cash gifts.

HOW LONG IS MY COMMITMENT?

Two years. Your commitment will culminate in March 2022.

IMPORTANT DATES

Advance Commitment Night: February 16 | 7:00 p.m. | Worship Center

If you're ready to make your commitment early, come and worship together!

Commitment Sunday: March 1

In all worship services, we will take time to pray and worship together around the commitments God is calling us to.

First Big Give: March 29

Celebrate together in all worship services what our collective commitment is, and make your first contribution to the Forward campaign.

GIVING CHART

As you pray and discern how God would ask you to give during this time, use this gift chart as a discipleship tool—let it be something that inspires and challenges you towards greater generosity for Christ's Kingdom.

GIFTS NEEDED	TWO YEAR GIFT LEVEL	ANNUAL GIFT	MONTHLY GIFT	GIFT LEVEL TOTAL
1	1,000,000	500,000	41,667	1,000,000
2	500,000	250,000	20,833	1,000,000
2	250,000	125,000	10,417	500,000
3	150,000	75,000	6,250	450,000
4	125,000	62,500	5,208	500,000
5	100,000	50,000	4,167	500,000
7	75,000	37,500	3,125	525,000
8	65,000	32,500	2,708	520,000
15	50,000	25,000	2,083	750,000
20	35,000	17,500	1,458	700,000
25	25,000	12,500	1,042	625,000
40	15,000	7,500	625	600,000
55	10,000	5,000	417	550,000
80	7,500	3,750	313	600,000
90	5,000	2,500	208	450,000
Many	2,500	1,250	104	330,000
Total Goal				\$9,600,000

ANY QUESTIONS?

Contact us at (316) 722-5885 or email Becky at bklassen@firstmbchurch.org.

SERM

+ STU

MONS

UDIES

MESSAGE NOTES

February 2 | Irrational (Rational) Giving
2 Corinthians 8:1-7

MESSAGE NOTES

February 9 | Genuine Love is Financially Generous
2 Corinthians 8:8-15

MESSAGE NOTES

February 16 | Eagerness

2 Corinthians 8:16-24

MESSAGE NOTES

February 23 | Cheerful Generosity

2 Corinthians 9:1-9

MESSAGE NOTES

March 1 | The Ripple Effect of Generosity
2 Corinthians 9:10-15



LIFEGROUP QUESTIONS

Week 1 | Irrational (Rational) Giving

OVERVIEW: (2 Corinthians 8:1-7)

The Apostle Paul writes in this passage about the grace given to the churches at Macedonia (which were three different churches – Thessalonica, Philippi, and Berea), as they gave generously – even **out of their poverty**.

This passage is so profound because it illustrates not only a church giving entirely of their own accord, TO another church (the church across the sea in Jerusalem) whom they would more than likely never see nor meet; but it also illustrates the ability of a church in extreme poverty and affliction to give generously – even beyond their means – with overwhelming joy.

DISCUSSION QUESTIONS:

- 1) What is significant about the way in which the Macedonian churches gave?

- 2) What does it mean that the Macedonian churches gave themselves “first to the Lord” as they gave?

- 3) Have you ever spent significant time with the Lord prior to making a decision about your giving?

4) The realities and pressures of life and financial strain often try to hinder us from truly giving ourselves to the Lord before we decide how and what to give. How can you guard yourself against this?

5) If you are truly honest, does your giving drive your spending and your saving; or does your spending and saving drive your giving? Why is this so?

6) What would have to be different in your life if your giving drove all of your other decisions? How would this change your perspective and your other financial decisions?

7) Paul makes a specific point about excelling in this grace of giving (verse 7), just as we excel in other areas of our faith as well. Why do you think he felt the need to single-out giving like this and to utilize other areas of our faith to “persuade” the Corinthian church to give in this way? Why is giving such a particularly difficult – and sometimes even polarizing – part of our faith? How can we overcome this?



Watch a quick video teaching from Pastor Brent about this week's LifeGroup discussion at forwardwichita.org/resources.

LIFEGROUP QUESTIONS

Week 2 | Genuine Love is Financially Generous

OVERVIEW: (2 Corinthians 8:8-15)

The Apostle Paul obviously desires that the church at Corinth will contribute to relief of the Jerusalem church. But he doesn't just care that they give. He cares even more *why* they give. He could easily say, "You made a commitment. I was counting on it. Follow through!" But he doesn't say that. Instead, he works very hard to free them from bad motivations for giving. "I say this not as a command..." (verse 8). He wants them to be free from guilt, duty, obligation, pressure, and everything else as they give.

DISCUSSION QUESTIONS:

1) What are some of the trappings of giving that we often fall into as Christ followers? Another way of asking this might be, what are some of the lies we believe about giving to the local church?

2) What are some of the key truths the Apostle Paul is saying to us about giving in this passage?

3) Paul reminds us in verse 9 about what our Lord and Savior did for us and the incredible debt we could never (and are not being asked to) repay. How does this remembrance of what Christ did for us affect how you give? Would you say you give in a way that is driven by the gospel? Or is it driven by other things?

4) Paul reminds the Corinthians of their prior desire to give as he encourages them to yet again do so. Do you find your willingness to give ebbing and flowing with the seasons of your life? Why is this so? And how might this be different if you were to base your desire to give on things other than your circumstances and ability?

5) Verse 12 is a powerful reminder that we are not being asked to give what we don't have. We are being asked to give, however, from what we do have. We often make excuses of why we don't give, stating, "Well, if I made more money or had more margin, then I would give." But God knows your situation; He is the one who gave it to you. So let us ask ourselves a convicting question: If you were God, would you give you more money?



Watch a quick video teaching from Pastor Brent about this week's LifeGroup discussion at forwardwichita.org/resources.

LIFEGROUP QUESTIONS

Week 3 | Eagerness

OVERVIEW: (2 Corinthians 8:16-24)

In this passage the Apostle Paul writes about how passionate and trustworthy those who are going to be aiding in the collection and carrying of the offering are, which are Titus and the “two [unnamed] brothers.” Paul is seeking to convey to these early believers that these men are not only trustworthy but are passionate as well and should not be let down as the offering is received. While our giving is to be done to God and not to man, it is important to note that Paul felt it necessary to mention the credibility of these men as to further compel these believers to give without reservation and in full joy.

DISCUSSION QUESTIONS:

1) What are your observations about the passion described of Paul, Titus, and the “two brothers” who were aiding in the collection and carrying of the offering in this passage? How does this affect you as you think about your own desire to give?

2) Have you ever let your questions about the local church hinder your generosity to God?

3) What role does trust play into your generosity – both trust in God as well as trust in the leaders whom God has put in place at First MB? Is this an area of growth for you, or would you say you might be someone who could help others along in this area?

4) What does it mean that Paul, Titus, and the two “brothers” had an eagerness to serve in this offering collection?

5) Would you call your desire to give “eager”? And would anyone ever call upon you to be one of those who will help receive and carry the collection for the Lord? If not, what hinders your eagerness, and how does God desire for you to change?

6) As you think about the Forward initiative and this next season for First MB, what causes you to be “eager” about this new day ahead?



Watch a quick video teaching from Pastor Brent about this week's LifeGroup discussion at forwardwichita.org/resources.

LIFEGROUP QUESTIONS

Week 4 | Cheerful Generosity

OVERVIEW: (2 Corinthians 9:1-9)

The Apostle Paul speaks here once again about the importance of the heart behind the gift. He not only expresses that he hopes the Corinthians do not let him down in what they had previously been eager to do in their giving but that also they don't rise to the occasion merely out of obligation or duty (or because he is saying to do so) but rather because of genuine joy in generosity. He also is careful (verse 4) to ensure the Corinthians know he would never speak ill of them to the Macedonians but rather that he would put it on himself for being incorrect about their generous gift. Paul's transparency in this passage is inspiring as he vulnerably shares with these believers his heart in desiring them to give. He reiterates his heart behind the matter in the well-known words of verses 6-9, just in case there were any questions about the true nature of what he is asking them to do.

DISCUSSION QUESTIONS:

1) Most people genuinely do desire to be generous; that's typically not the challenging issue. More often the challenging issue is giving of ourselves in a way that erodes selfishness and replenishes generosity. In what ways do you feel your selfishness still creeping in occasionally as it relates to your generosity? What might you do in order to combat that?

2) Have you ever promised something to someone that you feel you can't fulfill? How did that make you feel, and why did you feel that way?

3) Does guilt or shame ever play into your mind as you consider what to give? Is it playing into your mind as you consider this Forward season currently? Be as transparent as you can with your LifeGroup, as they seek to support you in prayer, grace, and release from obligation and compulsion - as the Apostle Paul invites.

4) Paul desires for these early believers to truly enjoy the fruit of their contribution. Take some time to discuss and “enjoy” the possibilities of what is to come in this next season of ministry at First MB with our “New Day.” What excites you about the future of First MB?

5) When you enjoy a “harvest of righteousness,” how does that affect your heart and desire towards giving? How might your heart be more oriented towards the future as opposed to the past as it relates to your giving to God’s mission?



Watch a quick video teaching from Pastor Brent about this week’s LifeGroup discussion at forwardwichita.org/resources.

LIFEGROUP QUESTIONS

Week 5 | The Ripple Effect of Generosity

OVERVIEW: (2 Corinthians 9:10-15)

In this passage the Apostle Paul speaks about the multiplicative effect of generosity and how our giving is not only about those we will give TO but also about the heart in which we give FROM. Paul encourages us to give generously, sharing that other people see God as we give. In essence, Paul is saying, "Generosity doesn't just *fund* the mission; it is the mission."

DISCUSSION QUESTIONS:

1) Read verse 11 and ask yourself this question: If the purpose of us having resources is so that we can give them away, would you call yourself a "good steward" of what God has given you? Why or why not?

2) Verses 12 and 13 speak of the evangelistic effect of generosity. As you consider your commitment to the Forward campaign, are you giving in such a way that will create a witness and draw more people to God as they hear your story? What might that look like for you?

3) As referenced in the prior question, verse 13 speaks to the aspect of sharing your story of generosity with someone else. Would you be willing to do that? In the following weeks, there may be opportunities for you to share the heart behind your commitment (not specific numbers). Prepare yourself now. If asked to share about your journey, what would you say?

4) This particular offering was being received for the churches in Jerusalem – a group of churches who desperately needed the Corinthians help and generosity. As you think about a people group in Wichita who desperately needs our spiritual help and generosity, who comes to mind? How is our Forward campaign helping to make that happen, and what excites you about this as you give?

5) Write out your prayer for these next two years of the Forward campaign. If so bold, share your prayer out loud with the group, and everyone pray for one another as we begin the next two years (and beyond) of this adventure together.



Watch a quick video teaching from Pastor Brent about this week's LifeGroup discussion at forwardwichita.org/resources.

GIVING FORWARD

FAMILY GUIDE

It's important to us that all ages and every member of the family is involved in this campaign.

That's why we're excited to have kids and families join us on this Forward adventure! Throughout this series, our kids will explore Bible stories of abundant giving and sharing. These stories will challenge your kids to give generously and to share Jesus' love with everyone.

Parents, here are a few main points you can review with your kids:



MEMORY VERSE:

"I push myself forward toward the goal to win the prize. God has appointed me to win it. The heavenly prize is Christ Jesus Himself." Philippians 3:14 (NIRV)



LIFE APPLICATION:

Make someone's day by giving something away.



BASIC TRUTH:

I can trust God no matter what.



Looking for pointers on how to implement these ideas at home? We've got a bunch of ideas ready for you.

firstmbchurch.org/giving-forward

FOR WARD

STUDENTS ARE ALL IN, TOO.

Our junior high and high school students are also participating in the campaign.

The student campaign is centered around two main ideas:

GIVE

In addition to tithing, we'll encourage our students to find unique ways to give financially by selling things they don't need.

SHARE

We'll provide evangelism training, encouraging our students to pray about and track progress with sharing their faith with friends.



THERE'S MORE ONLINE.

Watch videos.
Give anytime.
Get the latest updates.

ForwardWichita.org

 firstmbchurch

real people | real faith | real impact
8000 W. 21st St. | Wichita, KS 67205
(316) 722-5885 | firstmbchurch.org