

CENTRAL CHURCH OF CHRIST



GIVING A REASON FOR
THE HOPE WITHIN

hope & grace

THE CROSS OF CHRIST GIVES HOPE

SEPTEMBER 14, 2025



WE'RE GLAD YOU'RE HERE

WHETHER YOU'RE VISITING OR A REGULAR,
WE'RE GLAD YOU'RE HERE! WE PRAY TODAY'S
WORSHIP ENCOURAGES YOUR HEART AND
STRENGTHENS YOUR FAITH.

**"BUT SANCTIFY THE LORD GOD IN YOUR HEARTS, AND
ALWAYS BE READY TO GIVE A DEFENSE TO EVERYONE
WHO ASKS YOU A REASON FOR THE HOPE THAT IS IN
YOU, WITH MEEKNESS AND FEAR" (1 PETER 3:15, NKJV)**

FAMILIES WITH YOUNG CHILDREN

WE OFFER **WEE WORSHIP** FOR CHILDREN AGES
2-7 DURING THE SERMON & **NURSERY CARE**
FOR BABIES AND TODDLERS. RESTROOMS ARE
LOCATED IN THE MAIN HALLWAY.

CONNECT WITH US

WHETHER YOU'RE A FIRST-TIME GUEST OR A
REGULAR MEMBER, WE'D LOVE TO KNOW
YOU'RE HERE! HERE ARE SOME OPTIONS:

TEXT "**CHECK IN**" TO **706-278-8051**

FILL OUT A **CONNECT CARD** (BACK OF SEAT)



SCAN THE **QR CODE** TO FILL OUT
OUR DIGITAL CONNECT CARD

[CCOCDALTON.ORG/CONNECT-CARD](https://ccocdalton.org/connect-card)

ORDER OF SERVICE

SEPTEMBER 14, 2025

Call to Worship	Josh Holloway
<i>You Are The Song I Sing</i>	Ross Jordan
<i>Awesome God</i>	Ross Jordan
Prayer	Ross Jordan
<i>Soldiers of Christ Arise</i>	Ross Jordan
Welcome	Jeremy & Ben
<i>In Christ Alone</i>	Ross Jordan
Communion Prayers	Terry Shepherd
<i>I'm In The Lord's Army</i>	Ross Jordan
Children's Chat	Josh & Aidan
Scripture Reading - Luke 23:39-43	Sam Lewis
<i>Shout To The Lord</i>	Ross Jordan
Sermon	Shane Robinson
<i>Bring Christ Your Broken Life</i>	David Byerly
Shepherd's Moment	Bob Lee
<i>Gloryland Way</i>	David Byerly
Closing Prayer	John Cox

Greeters

Rachel Kirkland & Jane Cherry, Mel & Sylvia Sane

Nursery Attendants

Luanne Holloway & Chrissie Smith

Wee Worship

Sam & Samantha Lewis, Hannah Kresser & Sophie Robinson

Serve Communion in September

T. Coley, R. Milburn, M. Sane, C. Goble, N. Bennett,
L. Martinez, R. Stanley, J. Cook

LESSON OUTLINE

hope & grace

THE CROSS OF CHRIST GIVES HOPE

THE CROSS **REVEALS** OUR PROBLEM

- Sin in the Garden: Sin entered the world, and death was the _____ (Gen. 2:17; Rom. 5:12).
- Hope in the Garden: Even before judgment, God promised a _____ (Gen. 3:15; Gal. 4:4).
- Shame in the Garden: God accepted the death of _____ and covered Adam and Eve's shame (Gen. 3:21; Lev. 17:11; Heb. 9:22).

THE CROSS **REDIRECTS** US TO GOD'S PLAN

- Sin Addressed: The _____ of the crucifixion shows God's plan unfolding (Mk. 15:23, 33, 34-37; cp. Ex. 10; 12).
- Barriers Removed: The _____ of the veil from top to bottom shows that God Himself opened the way back into His presence (Mk. 15:38; Heb. 10:19-22).
- Hope Secured: The _____ shows us that Jesus entrusted Himself to God in death and trusted Him to make wrongs right (Ac. 2:24, 32; Rom. 8:11; Job 19:25-27).

THE CROSS RESTORES OUR HOPE

Case study: Luke 23:39-43

- _____ Pain: On the cross, Jesus bore Adam's curse on the tree and shared the sufferings of the two thieves (Isa. 53:12; Heb. 2:14, 17-18).
- _____ Pain: On the cross, Jesus endured our shame and reproach, yet answered the penitent thief with grace (Heb. 12:2; Gal. 3:13).
- _____ Pain: On the cross, Jesus opened the way back to the tree of life, replacing eternal separation with eternal life (1 Pet. 2:24; Rev. 22:2-3).

D I G G I N G D E E P E R

1. Why is it important to see that death was the consequence of sin from the very beginning (Gen. 2:17; Rom. 5:12)?
2. How does the timing of Jesus' crucifixion deepen your understanding of God's plan for redemption (Mk. 15; Ex. 12)?
3. How does Jesus' interaction with the repentant thief show that no one is beyond the reach of hope (Lk. 23:39-43)?
4. If someone asked you this week, "Why do you have hope in Jesus?" what part of the cross would you share with them?

classes

STAY AND GROW WITH US

AFTER OUR WORSHIP ASSEMBLY, WE INVITE EVERYONE TO **STICK AROUND FOR BIBLE CLASSES** BEGINNING AROUND 10:50 AM.

CURRENT CLASSES OFFERED:

ADULTS: AUDITORIUM (DIGGING DEEPER)

SENIORS: RM 130 (PRIMETIMERS)

MIDDLE AGE: RM 134 (INBETWEENERS)

YOUNG ADULTS: RM 132 (PATHFINDERS)

COUPLES: RM 131 (YOUNG MARRIED)

COLLEGE: RM 133 (WAYFINDERS)

TEENS: RM 250 (2ND FLOOR)

ELEMENTARY: RM 248 (2ND FLOOR)

PRE K: RM 141 (NEAR FELLOWSHIP HALL)

CRADLE ROLL: RM 135 (IN NURSERY AREA)

BUILDING LAYOUT

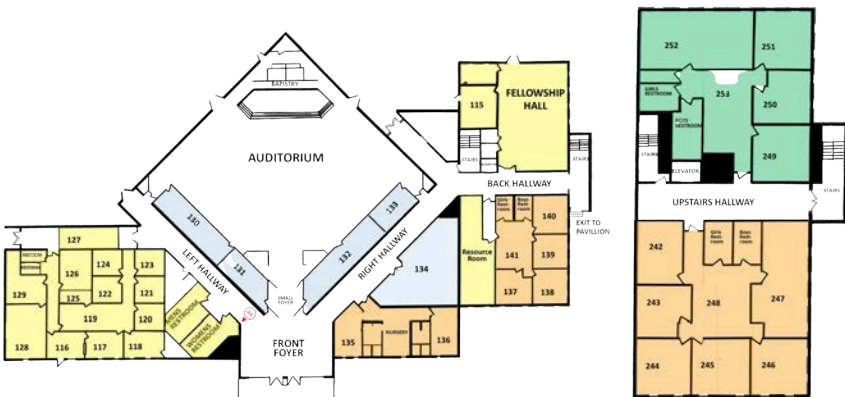



U P C O M I N G E V E N T S

FALL LIFE GROUPS BEGIN - SAT, SEPT. 13

A. SHEPHERD BRIDAL SHOWER - SUN, SEPT. 14 @ 4 PM

ELDER INSTALLATION SERVICE - SUN, OCT. 5

CONGREGATIONAL FELLOWSHIP MEAL - SUN, OCT 5

MENS RETREAT - OCT. 9-12

BLOOD DRIVE - WED, OCT. 22

BOO BASH - SUN, OCT. 26 @ 4:30 PM

O N G O I N G E V E N T S

AM WORSHIP - SUN @ 9:30 AM

SUNDAY BIBLE CLASSES - AFTER WORSHIP (10:50 AM)

LADIES BIBLE CLASS - TUES @ 10:30 AM (RM 134)

FOOD & CLOTHING - TUES & THURS 10 AM - 12 PM

WED NIGHT MEAL - WED @ 5:45 PM (FELLOWSHIP HALL)

WED BIBLE STUDY - WED @ 6:30 PM (ALL AGES)

LIFE GROUPS - VARIOUS TIMES & LOCATIONS

C E N T R A L C H U R C H O F C H R I S T

515 NORTH TIBBS ROAD
DALTON, GA 30720
706-278-8051

WWW.CCOCDALTON.ORG
CENTRALCOC@CCOCDALTON.ORG
FACEBOOK.COM/CENTRALCOCDALTON

Scripture

R E A D I N G

LUKE 23:39-43

Then one of the criminals who were hanged blasphemed Him, saying, "If You are the Christ, save Yourself and us." But the other, answering, rebuked him, saying, "Do you not even fear God, seeing you are under the same condemnation? And we indeed justly, for we receive the due reward of our deeds; but this Man has done nothing wrong." Then he said to Jesus, "Lord, remember me when You come into Your kingdom." And Jesus said to him, "Assuredly, I say to you, today you will be with Me in Paradise." (Luke 23: 39-43, NKJV)

The New King James Version. Thomas Nelson, 1982.