

NEXT STEPS

Date \_\_\_\_/\_\_\_\_/\_\_\_\_

Name \_\_\_\_\_

Your Age Group  
 18-22 23-30 31-35 36-40  
 41-45 46-50 51-60 61-70 71+

or

Current School Grade  
 K 1 2 3 4 5 6  
 7 8 9 10 11 12 College

Please Indicate:  Single  Married

Address \_\_\_\_\_

City \_\_\_\_\_

State \_\_\_\_\_ Zip \_\_\_\_\_

Phone: \_\_\_\_\_

Email \_\_\_\_\_

I'd like to receive church communications via:  
 Text  Email  Both

Is this your...  
 1st Time?  2nd Time?  3rd Time?

I am an:  Attender  Member

I came as a guest of \_\_\_\_\_

Names of children living at home & birthdates:  
 \_\_\_\_\_  
 \_\_\_\_\_  
 \_\_\_\_\_

Fold and Tear Here

My Decision Today:

I'm committing my life to Christ

I want to be baptized

I'm renewing my commitment to Christ

Enroll me in the next...

Class 101 How to Connect

Class 201 How to Grow

Class 301 How to Serve

Class 401 Discovering My Life Mission

Class 501 Discovering Worship

I'm interested in joining a Small Group

I'd like info about Celebrate Recovery

I'm willing to help where needed

I'd like to talk to a staff minister

MAPS & PARKING

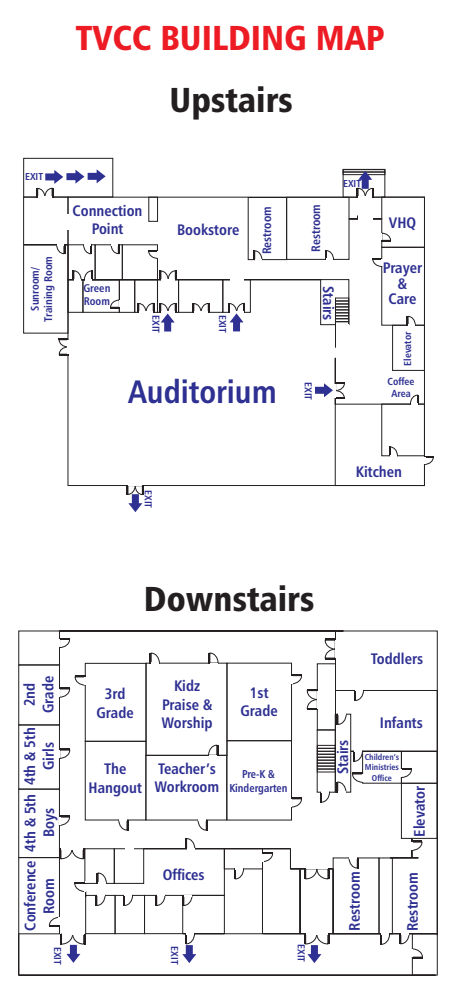

Please ENTER the TVCC campus off WOOD STREET and EXIT on PEPPERS DRIVE.

This is to help the flow of traffic between services and for the safety of everyone!

CHURCH WIDE OPPORTUNITIES continued...

TVCC offices will be closed tomorrow in observance of New Year's Day. They will reopen on Tuesday, January 2nd

**WAYS TO GIVE**

You can give online through the website at tvcc.us or through the TVCC app.

You can give in person using the envelopes provided in the seat backs and place those in the bags at the auditorium exits.

You can also mail your gift or tithe to: 2500 East Wood Street, Paris, TN 38242 or feel free to drop it by the church office.

*Giving Statements*

Giving statements will be emailed from Churchteams on January 15, 2024.

Please contact the office if your email has changed or if you would like to pick up a paper copy of your giving record.

**OFFICE NUMBER: 731-641-8822**

Christmas Photo Ops are located upstairs by the main entrance and downstairs by the children's entrance.

Share your photos on social media using the hashtag **#TVCC2023Christmas**

One last chance to grab some holiday photos with our beautiful backdrops!

**STATE OF THE PEOPLE**

**STATE OF THE CHURCH**

"This means that anyone who belongs to Christ has become a new person. The old life is gone; a new life has begun!" 2 Corinthians 5:17

STATE OF THE PEOPLE

STATE OF THE CHURCH

"This means that anyone who belongs to Christ has become a new person. The old life is gone; a new life has begun!" 2 Corinthians 5:17

