

# The Heart of Worship



MARK MOORE





**On the next day, when they had left Bethany, He became hungry. Seeing at a distance a fig tree in leaf, He went to see if perhaps He would find anything on it; and when He came to it, He found nothing but leaves, for it was not the season for figs. He said to it, “May no one ever eat fruit from you again!” And His disciples were listening.**

**Then they came to Jerusalem. And He entered the temple and began to drive out those who were buying and selling in the temple, and overturned the tables of the money changers and the seats of those who were selling doves; and He would not permit anyone to carry merchandise through the temple.**

**MARK 11:12-25 (NASB)**



**And He began to teach and say to them, “Is it not written, ‘My house shall be called a house of prayer for all the nations’? But you have made it a robbers’ den.” The chief priests and the scribes heard this, and began seeking how to destroy Him; for they were afraid of Him, for the whole crowd was astonished at His teaching.**

**When evening came, they would go out of the city.**

MARK 11:12-25 (NASB)



**As they were passing by in the morning, they saw the fig tree withered from the roots up. Being reminded, Peter said to Him, “Rabbi, look, the fig tree which You cursed has withered.” And Jesus answered saying to them, “Have faith in God. Truly I say to you, whoever says to this mountain, ‘Be taken up and cast into the sea,’ and does not doubt in his heart, but believes that what he says is going to happen, it will be granted him. Therefore I say to you, all things for which you pray and ask, believe that you have received them, and they will be granted you. Whenever you stand praying, forgive, if you have anything against anyone, so that your Father who is in heaven will also forgive you your transgressions.**

**MARK 11:12-25 (NASB)**



**On the next day, when they had left Bethany, He became hungry. Seeing at a distance a fig tree in leaf, He went to see if perhaps He would find anything on it; and when He came to it, He found nothing but leaves, for it was not the season for figs. He said to it, “May no one ever eat fruit from you again!” And His disciples were listening.**

**MARK 11:12-14**





**Then they came to Jerusalem. And He entered the temple and began to drive out those who were buying and selling in the temple, and overturned the tables of the money changers and the seats of those who were selling doves; and He would not permit anyone to carry merchandise through the temple.**

MARK 11:15-16





**As they were passing by in the morning, they saw the fig tree withered from the roots up. Being reminded, Peter said to Him, “Rabbi, look, the fig tree which You cursed has withered.”**

MARK 11:20-21





**“I will surely snatch them away,” declares the Lord;  
“There will be no grapes on the vine  
And no figs on the fig tree,  
And the leaf will wither;  
And what I have given them will pass away.”**

JEREMIAH 8:13





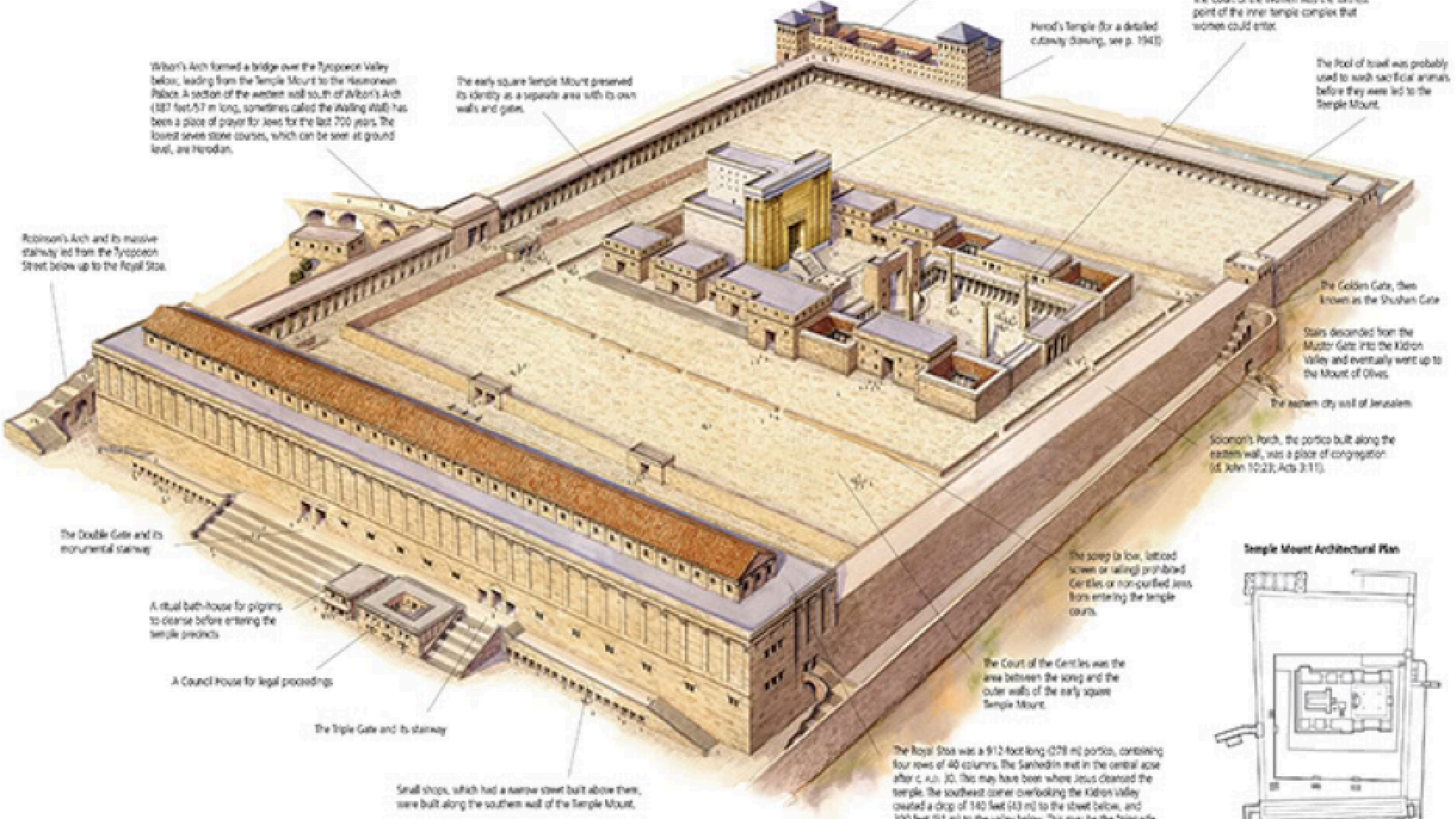

Wilson's Arch formed a bridge over the Tyropoeon Valley below, leading from the Temple Mount to the Herodian Palace. A section of the western wall south of Wilson's Arch (187 feet/57 m long, sometimes called the Wailing Wall) has been a place of prayer for Jews for the last 700 years. The lowest seven stone courses, which can be seen at ground level, are Herodian.

The early square Temple Mount preserved its identity as a separate area with its own walls and gates.

Herod's Temple (for a detailed cutaway drawing, see p. 194)

The pool of water was the eastern point of the inner temple complex that women could enter.

The Pool of Israel was probably used to wash sacrificial animals before they were led to the Temple Mount.

Robinson's Arch and its massive stairway led from the Tyropoeon Street below up to the Royal Stoa.

The Golden Gate, then known as the Shushan Gate

Stairs descended from the Master Gate into the Kidron Valley and eventually went up to the Mount of Olives.

The eastern city wall of Jerusalem

Solomon's Porch, the portico built along the eastern wall, was a place of congregation (cf. John 10:23; Acts 3:11).

The Double Gate and its monumental stairway

The song (a low, latticed screen or railing) prohibited Gentiles or non-purified Jews from entering the temple courts.

A ritual bath-house for pilgrims to cleanse before entering the temple precincts

The Court of the Gentiles was the area between the song and the outer walls of the early square Temple Mount.

A Council House for legal proceedings

The Triple Gate and its stairway

The Royal Stoa was a 912-foot-long (278 m) portico, containing four rows of 40 columns. The Sanhedrin met in the central aisle after c. A.D. 30. This may have been where Jesus cleansed the temple. The southwest corner overlooking the Kidron Valley created a drop of 140 feet (43 m) to the street below, and 100 feet (30 m) to the valley below. This was the base of the Temple Mount.

Small shops, which had a narrow street built above them, were built along the southern wall of the Temple Mount.

Temple Mount Architectural Plan

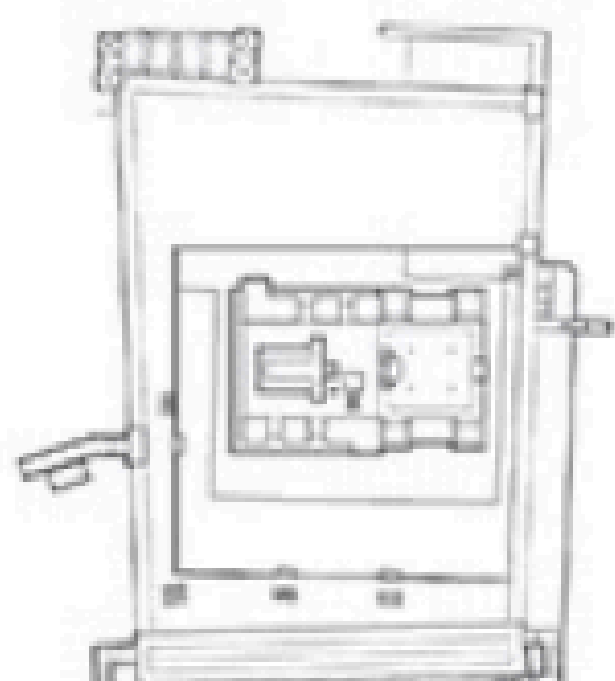



*What Was Missing?*

**Fear, Reverence and Awe Before God**



**Now when Solomon had finished praying, fire came down from heaven and consumed the burnt offering and the sacrifices, and the glory of the Lord filled the house. The priests could not enter into the house of the Lord because the glory of the Lord filled the Lord's house. All the sons of Israel, seeing the fire come down and the glory of the Lord upon the house, bowed down on the pavement with their faces to the ground, and they worshiped and gave praise to the Lord, saying, "Truly He is good, truly His lovingkindness is everlasting."**

**2 CHRONICLES 7:1-3**



**In the year of King Uzziah's death I saw the Lord sitting on a throne, lofty and exalted, with the train of His robe filling the temple. Seraphim stood above Him, each having six wings: with two he covered his face, and with two he covered his feet, and with two he flew. And one called out to another and said,**

**“Holy, Holy, Holy, is the Lord of hosts,  
The whole earth is full of His glory.”**

**And the foundations of the thresholds trembled at the voice of him who called out, while the temple was filling with smoke.**

**ISAIAH 6:1-4**



**and He would not permit anyone to carry  
merchandise through the temple.**

MARK 11:16





**Then I said,  
“Woe is me, for I am ruined!  
Because I am a man of unclean lips,  
And I live among a people of unclean lips;  
For my eyes have seen the King, the Lord of  
hosts.”**

ISAIAH 6:5





**Now while Ezra was praying and making confession, weeping and prostrating himself before the house of God, a very large assembly, men, women and children, gathered to him from Israel; for the people wept bitterly.**

**EZRA 10:1**





*What Was Missing?*

**Confession and Sorrow Over Sin**



**And He began to teach and say to them, “Is it not written, ‘My house shall be called a house of prayer for all the nations’? But you have made it a robbers’ den.”**

MARK 11:17





**Yet they did not obey or incline their ear, but walked in their own counsels and in the stubbornness of their evil heart, and went backward and not forward.**

JEREMIAH 7:24





*What Was Missing?*

**Faithful and Forgiving Prayer**



**And Jesus answered saying to them, “Have faith in God. Truly I say to you, whoever says to this mountain, ‘Be taken up and cast into the sea,’ and does not doubt in his heart, but believes that what he says is going to happen, it will be granted him. Therefore I say to you, all things for which you pray and ask, believe that you have received them, and they will be granted you.**

MARK 11:22-24





**Whenever you stand praying, forgive, if you have anything against anyone, so that your Father who is in heaven will also forgive you your transgressions.**

MARK 11:25





**And Jesus uttered a loud cry, and breathed His last. And the veil of the temple was torn in two from top to bottom.**

MARK 15:37-38





How Is Your Heart  
Prone to Miss True  
Worship?