

living the vision
**FOR THE NEXT
GENERATION**

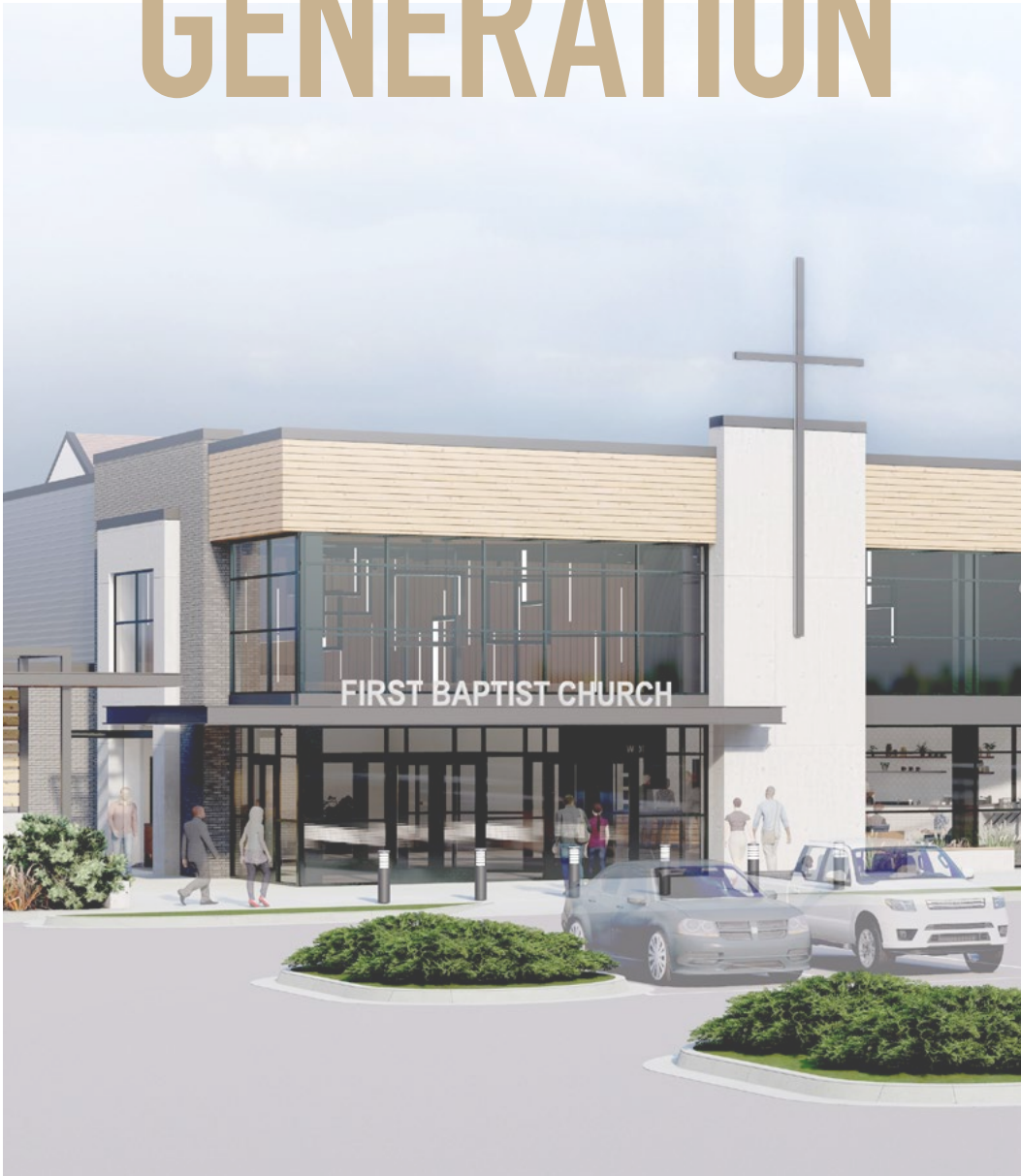

EPHESIANS 3:20-21

“Now to Him who is able to do far more abundantly than all that we ask or think, according to the power at work within us, to Him be glory in the church and in Christ Jesus throughout all generations, forever and ever. Amen.”

TABLE OF CONTENTS

2	Letter from Pastor Jeremy
4	Our Past
9	The Vision
11	Our Present
12	Our Future
26	Live the Vision
28	Future Phases
30	FAQ



from Pastor Jeremy

We are living in a day of incredible challenge, but also incredible opportunity. Since the Fall of Man, this is the way it has always been, and always will be, until Jesus Christ returns and makes all things right and new. Until then, the church of Jesus Christ has ONE mission: "Go and make disciples."

FBCN has always been a church with vision. Since its inception, this church has wanted to reach the people in its community. When the church moved to its current location in the 1970s, it was a bold statement that the church was willing to do what was necessary to reach the growing community of Newcastle. Through many ups and downs, FBCN has been a light in this community and has continued to Dig Deep into the Word of God and Reach Wide into the world with the Gospel. We praise God for all that has taken place through the ministry of FBCN.

We now have an opportunity like none other. The population of Newcastle is growing at a rapid rate, much faster than any other time in its history. People from all backgrounds and walks of life are moving into this community, most of which are unchurched and unsaved. All you have to do is take a quick drive around Newcastle to see the many neighborhoods and rooftops popping up literally everywhere you look. As Jesus said, "The fields are ripe for harvest."

The best days at FBCN are ahead of us. We need to see the need, meet the need, and live the vision for the next generation. Let us lock arms and commit to Dig Deep and Reach Wide, for now is the time to fulfill the mission God has placed before us.



OUR PAST

1905

First Baptist Church Newcastle (FBCN) has been engaging the lostness and brokenness of this world since 1905. The church has been through multiple locations, pastors, victories, and challenges, but the vision to reach people with the Gospel and teach them the truth of God's Word has always remained. As we like to currently say, "Dig Deep and Reach Wide."

1948

Once the church landed on the corner of Fox Lane and Main Street (where the Newcastle Public School Administration Building is currently located) in 1948, the church steadily grew each and every year.

1977-1978

In 1977, a bold vision was cast to relocate the church to its current location, which happened in 1978. With great faith, FBCN members launched into this new vision, but some significant challenges arose that caused the fulfillment of the vision to be incomplete.

2006

In 2006, we began a master plan that continues to the present day allowing us to modernize virtually every area inside the church. We are debt free, growing rapidly, and perfectly poised for the next phase of ministry.





YOU AND I BENEFIT FROM
 DECISIONS MADE DECADES
 AGO, AND NOW IS THE TIME
 FOR US TO LOCK ARMS
 AND LIVE THE VISION FOR
 THE NEXT GENERATION.





THE VISION

Lost. It's a word that keeps me up at night, drives me to my knees, and keeps me on my knees in prayer. It's a word that we are all familiar with. At one point in time or another we've all experienced the feeling of being lost. It's frightening enough to be physically lost, it's eternally terrifying to be spiritually lost. Nearly 30,000 people currently reside in the Tri Cities; Newcastle, Blanchard and Tuttle. The latest research would show that 6 out of 10 are unchurched. That means in our surrounding communities alone there are nearly 18,000 men, women and children who are lost, and that number continues to grow along with the population. It doesn't take long to look around our communities and see that darkness is settling in hearts, homes, marriages, and families. Suicide rates are on the rise. The bondage of addiction is wreaking havoc. Marriages and homes are breaking apart. Many are staggering, searching, seeking to live lives with meaning and purpose, but they're in the dark. They're lost. They have no hope.

I once was lost. You once were lost. We have walked in their shoes. But now we're found. And we have the incredible opportunity, responsibility, and privilege to help the lost find Jesus. **We get to push back the darkness in our cities with the light of the Gospel!**



GOD CONTINUES TO BUILD HIS CHURCH



OUR PRESENT

Across America, the pandemic has created difficulty and challenges for many churches to simply stay open. By God's grace, even in the midst of all the challenges, these last two years, FBCN set records in regard to baptisms, new members, and financial giving. Jesus Christ said, "I will build My church, and the gates of hell will not prevail against it," and we have seen that truth displayed right before our eyes. With three hours of worship, two hours of small groups, and countless hours of ministry and mission happening around the clock, the amazing Gospel-work taking place in and through our church is nothing short of the grace and power of Jesus Christ. God continues to build His Church.

OUR FUTURE

The fields are ripe for harvest and FBCN must continue to take steps to be a church that reaches the people God is bringing to us. Just as the church needed a bold new vision to relocate in 1977 in order to reach the growing population of Newcastle, so now, a bold vision is needed that will extend for the next fifty years.

On January 9, 2022, FBCN voted overwhelmingly to begin plans for a building expansion. This will include a new worship center, atrium, exterior face lift, and several points of remodel inside the facility. Your Elders, Staff, Finance Team, and Long-Range Planning Team have prayed deeply about this, and we believe this is exactly what the Lord has next for FBCN.

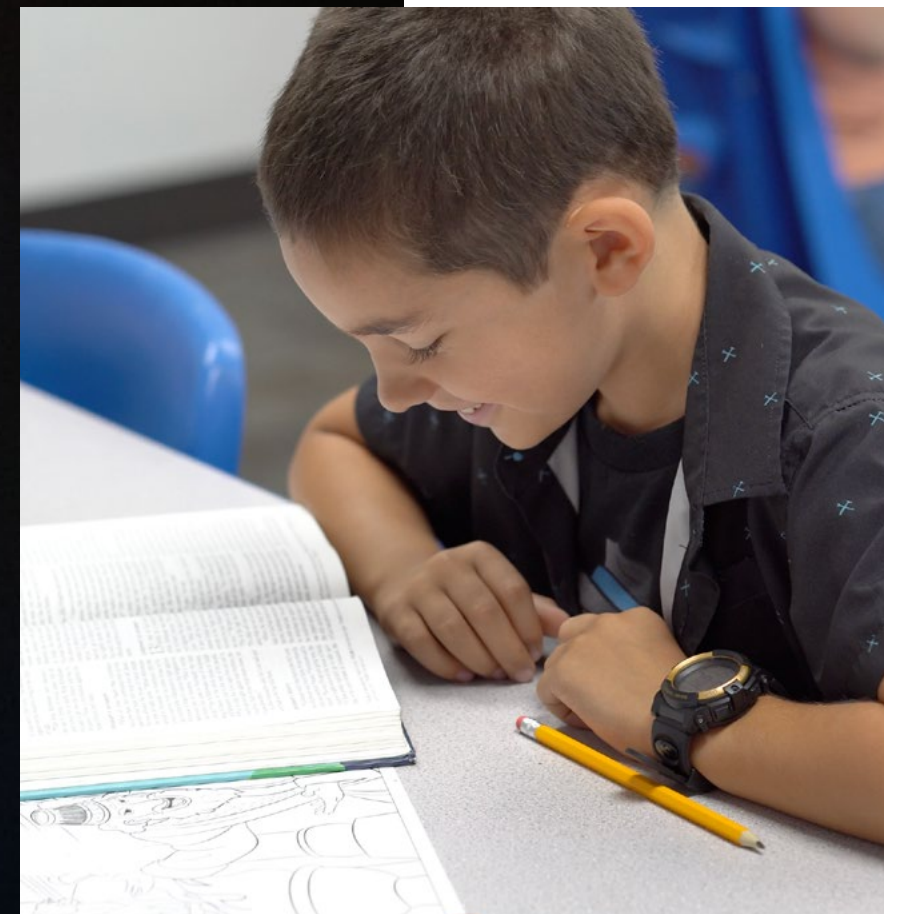



EXTERIOR FIRST IMPRESSIONS

Architectural styles change over time. The exterior of our current building has served us well for nearly 50 years. But like every organization, life requires change. If you're not changing and adapting you're dying. It is important for us to continue to have an appearance that is both welcoming and attracting to newcomers to our community and to our church. While the first impression is not primary, it is incredibly important. This project will include much needed updates to the exterior façade. Not only will it be a new space on the highway facing side of our property, it also includes plans to bring the majority of our current building into aesthetical alignment with the new building.



This project will include more glass, new modern textures and materials, welcoming colors, and better signage to welcome members and guests. It will include a very clear and prominent main entry point for those who are new to our campus!



It will also include a special outdoor space that will both serve to update the exterior façade but also provide a wonderful transition from the inside Atrium to the outside. It will be an intentional space from gathering for coffee throughout the week, to having d-groups, or even small groups outside when the weather is nice.



There will be a large overhead door that takes you from the atrium to this outside space, allowing for a dual purpose space in the spring, summer and fall.

THE ATRIUM

In 2019, we repurposed a central part of our facility and named it the "Hub". This has proved to be such a needed space for community building, special events, and traffic flow on Sunday mornings. Included in this project is a nearly 6,000 sf. Atrium that includes a coffee shop, comfortable seating areas, and space to host dinner events of 300+ around tables. This space will have large windows bringing in lots of natural light, high ceilings, coffee shop, and several seating groups. This will foster a sense of family and community providing for a welcoming place for guests and members to gather before and after service to catch up on life. A focal point of the Atrium space will be that it is a clearly identifiable place of entry for our guests. The large glass front will provide a window into the community and life that happens every week at FBCN. Our welcome team will be positioned to welcome guests as they first come in and help direct them to anywhere they need to go on our campus.



WORSHIP CENTER

The Worship Center is the primary gathering place of every church. It's where we meet every week to express our faith collectively by worshipping Jesus corporately. It's where we gather to be fed week after week straight from God's Word. It is also the front door for many people who come to our church. It's their first encounter at FBCN. We've been blessed with a wonderful space for nearly 30 years where countless men, women, and children have come to grow, connect, and mature in their faith! We thank God for the many who sacrificed greatly to provide a space where people could have encounters with Jesus! We have done our very best over the years to maximize our space and get the most out of it we possibly could. We've updated chairs, carpet, paint, lighting, sound, video, etc. God has been good to us and blessed our efforts, and we've continued to see growth. We are currently in 3 worship services on Sunday morning, and have run out of space.

We have also made massive strides in providing a quality live streamed worship experience. While online gathering never replaces the in person gathering, the pandemic has reinforced the reality that more people will be reached in the future through technology. This new space will not only help us serve those physically in the worship center, but also those who are unable to be with us in person, allowing them to worship with us wherever they may be. Our vision is to create an environment that is worshipful. A space that makes much of Jesus, that eliminates distractions, and helps each person focus on God and His Word.

This Worship Center will have approximately 1200 seats. Half of those will be on the floor with the other half in raised stadium style seating. One of our desires with a larger worship space is to maintain the feel of intimacy. Stadium style seating and a wider room instead of a long narrow room helps accomplish this. It keeps everyone in the room closer to the stage, and thus maintaining the more intimate feel.

Another added benefit to the stadium seating is usable square footage under the stadium seating. This is where the coffee shop, security room, A/V control Room, and some storage will be added.





WE ARE ASKING YOU TO

SEE THE NEED

We have been placed right in the middle of one of the fastest growing communities in the state of Oklahoma. That's not by accident. This is a God thing, and He has positioned us for such a time as this. This is much bigger than a building. It's about continuing to Dig Deep and Reach Wide for generations to come! Pray for God to give you and others a vision to see the lostness around us and our opportunity to impact it with the Gospel.

**DIG DEEP.
REACH WIDE.**

GREATER THINGS ARE YET TO COME



WE ARE ASKING YOU TO

MEET THE NEED

Once God has burned this vision into your heart, just like He has ours, we are asking you to begin praying "God how can I help". We believe greater things are yet to come for FBCN. We are asking you to engage in the process and begin preparing your life now to help meet the need. That's more than just giving, it's engaging in ministry. It's engaging your neighbor. It's engaging in your community with the Greatest News of all time.

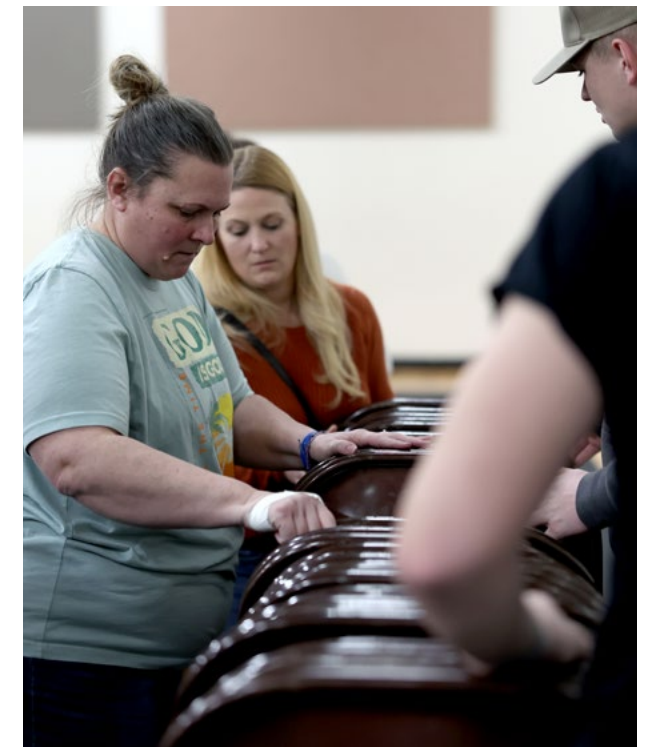

LIVE THE VISION

Invest your life and your resources into the vision God has put in your heart and in the heart of FBCN. The vision to Dig Deep and Reach Wide lives on, and NOW is the time for FBCN members to lock arms like never before and expand the footprint of our facility for future generations. You and I benefit from decisions made decades ago, and we must make decisions now, others will benefit from for decades to come!



CAMPAIGN GOAL: \$5,000,000

Our goal is to raise \$5,000,000 as a church family over the next 3 years. We are asking you to prayerfully consider what you could commit to invest over the next 3 years to help us meet this goal. We are asking our church family to submit a pledge card reflecting your 3 year commitment to help us meet our goal.

Commitments	Giving Amount	Total
1	\$400,000	\$400,000
2	\$200,000	\$400,000
2	\$150,000	\$300,000
2	\$125,000	\$250,000
3	\$100,000	\$300,000
5	\$70,000	\$350,000
10	\$50,000	\$500,000
10	\$48,000	\$480,000
10	\$42,000	\$420,000
10	\$35,000	\$350,000
10	\$25,000	\$250,000
235	\$4,255	\$1,000,000

Initial Campaign – \$5 million
Estimated Total Phase 1 Project – \$14.5 million

Make your pledge at fbcnewcastle.com/LTV

You can begin giving online at fbcnewcastle.com/give and select LTV.
 Or you can give by cash or check by designating it to LTV.

FUTURE PHASES / MASTER PLAN

1) CURRENT WORSHIP CENTER

The 405 student ministry is continuing to grow at record paces. Recently we have split the ministry into the 405 (High School) and 405 J-high (Middle School). We currently have two services on Wednesday Nights and two small group hours on Sunday mornings. The plan for the old Worship Center would be to repurpose it as a new 405 Student Ministry Space.

2) CURRENT 405 STUDENT SPACE

There are lots of possibilities for this space, but as our Kids Ministry continues to grow they will need a larger group meeting space. The current 405 space would be an excellent large group space for Elementary, especially our older Elementary (4th-5th graders).

3) OFFICES

Currently our staff offices are less than ideal. We are split up between two different areas in the church. In addition to being split up we have various offices for additional staff located all over our campus. Another challenge with our current offices is that they are in the middle of our campus. When someone enters the building it is a long ways to get to our offices. This poses challenges for people finding us, but also creates security challenges as they have access to the rest of the building once they're inside.

In the future, we would have one consolidated office space (3) with the potential to add more staff, a larger copy/work room, a conference room, and a commons space for collaboration which is a huge part of our team's regular work flow.

4) INTERIOR CENTRAL SPINE / WAYFINDING

One of the challenges in our current facility is wayfinding for guests and new members. Our building can be a bit of a maze. The Atrium will provide a wonderful front door/entry point, but then how does one find their way to Adult Education, Preschool, Students, Children's? Opening up the office hall, conference room, and media office will provide a larger corridor and also easier access to move from the Atrium to the rest of the ministry areas of the building.

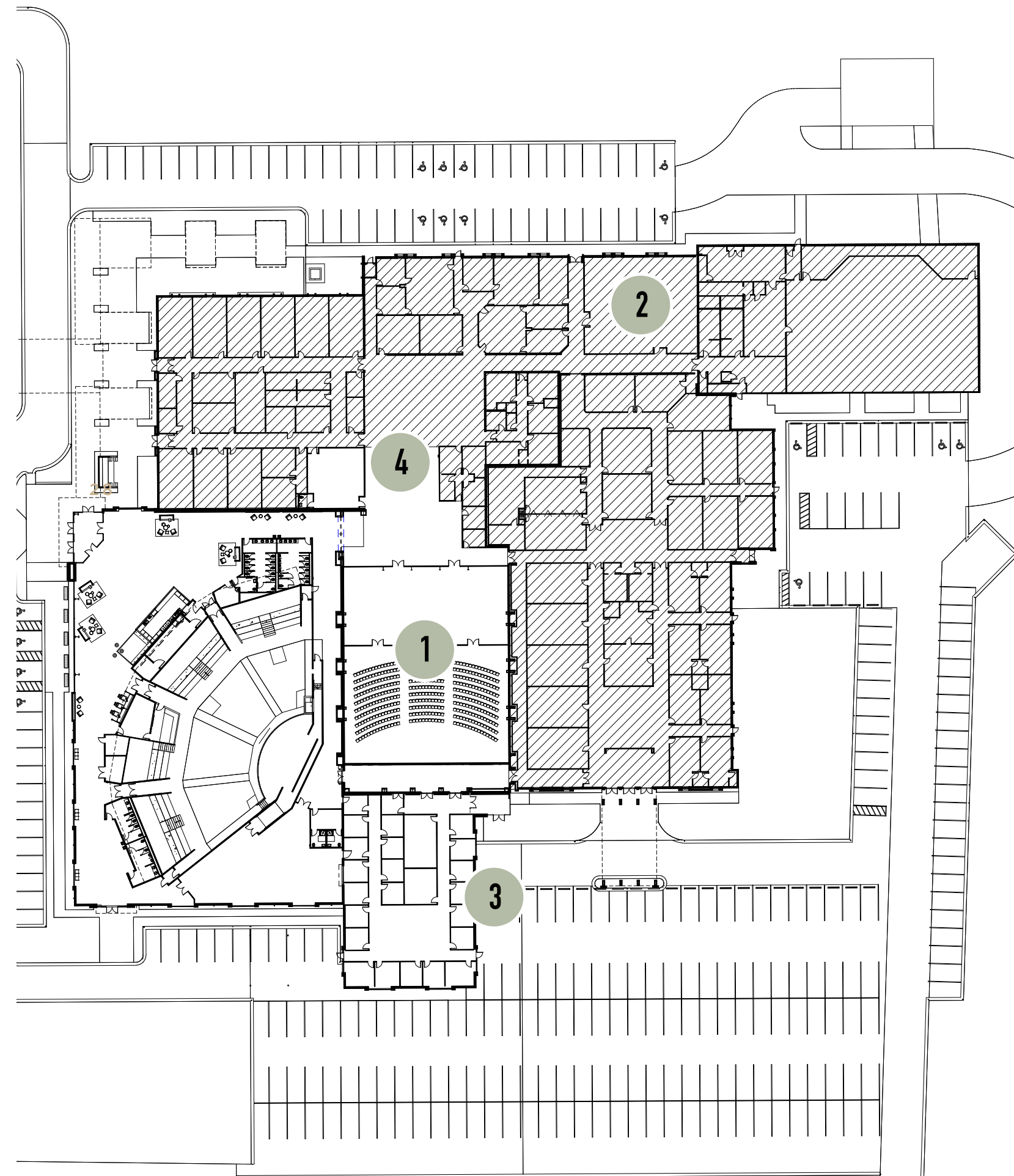

FAQ

1) How does my commitment to Living the Vision for the Next Generation affect my regular tithes and offerings?

Your 3-year commitment to Living the Vision should be above and beyond your regular tithes and offerings. We know this will require sacrifice, but it's important for the ministry and mission of FBCN to continue, which requires a continued commitment to the General Budget.

2) What are you asking me to do?

First and foremost, pray. Pray for Wisdom, for unity, and for God to do exceedingly, abundantly more than we can ask or think. Pray that God would give you clarity and direction on how to be a part of the great things God is doing in and through FBCN. Consider a 3-year commitment to helping us reach our goal for this initial campaign.

3) Are there additional ways besides cash that I can give more towards the project?

Be creative as you explore ways you and your family can give towards Living the Vision For the Next Generation. You might have stocks, property, or other items of that nature. Or you may have some stored resources that God has blessed you with in the past that He might be calling you to give out of during this time.

Please let our financial office know if you need assistance with facilitating gifts of property or stock, and we would be happy to help you with that. You can contact Lisa Wright at lisa@fbcnewcastle.com or 405.387.4366 to make a gift of this nature.

4) How long is my commitment?

We are asking that everyone make a 3-year commitment. The start of that commitment will be October 9, 2022 and the completion will be October 2025. We are asking that everyone bring as much of their commitment as possible on Harvest Sunday, October 23rd, 2022.

5) Is my pledge legally binding?

No. This is a spiritual commitment between you and the Lord. All pledges will be handled confidentially just like our regular giving through our Financial Office. Pledges will not be published. We understand that in a 3-year time period financial and life circumstances may change, the Lord may allow you to give more, or you may give less than your pledge. Our prayer is that you would follow His leading no matter what.

6) What if I have never given to FBCN before?

Our desire and prayer is that you would first seek the Lord and begin to grow in your understanding of the joy of Biblical stewardship. Our hope is that you'd start giving regularly and sacrificially to the Lord, so that the church can fulfill the mission God has given us.

7) Will we incur debt to accomplish this project?

The plan is yes, to finance the remaining portion we don't raise in this initial campaign. We are approved to finance up to \$10.5 million. The less we have to finance the better, which is why this initial campaign is so important. The more we can raise in this campaign, the less we have to finance. Any debt the church would incur will be voted on by the congregation at a Member Meeting. If we finance through WatersEdge (The Baptist Foundation) any interest paid goes to fund Baptist Causes (i.e. International Mission Board, North American Mission Board, Oklahoma Baptist Homes for Children, Baptist Retirement Villages, etc.).

8) If we raise \$5 million, how will we pay for the additional portion that is financed?

Our Finance Team is intentionally and aggressively planning to build into our General Budget our anticipated monthly payment over the next 3 budget cycles. This will allow anything that is brought in above and beyond our General Budget to go towards paying off the principal ahead of schedule.

Our desired goal would be to pay off the entire phase 1 by 2030. This will require intentional budget planning, as well as, continued commitment to giving towards Living the Vision for the Next Generation.

9) Can the project be phased?

Yes. We anticipate this being a 3-phase master plan. Phase 1 is the Atrium, Worship Center, and Exterior First Impressions.

10) When will construction start and when will we be in the new building?

Phase 1 construction is anticipated to begin Summer of 2023. Phase 1 construction completion is anticipated to be Summer of 2024. That means our hope is we will be worshipping in the new Worship Center sometime in the Summer of 2024.

11) Where will we worship while construction is taking place?

One of the benefits of our Architect and Construction Team is that they are able to complete construction without us being displaced from our existing Worship Center.

While there may be adjustment to parking and entrances to the facility, we will continue to operate as normal on Sundays and Wednesdays.

12) Will the new Worship Center allow for us to have one service and one small group hour?

We anticipate being in 2 worship hours and 2 small group hours with the new building.

13) Is this the best time to build with the economy and construction costs?

We believe this is the next step God has for us at FBCN. He has made this timing clear to the leadership of FBCN. There are always unknowns when it comes to the economy and construction costs. But in consultation with Lingo Construction, we believe that our timetable for bidding and beginning construction Spring and Summer of 2023 is the best time in the current market. Our last two years, financially, have been the strongest in our church's history, so in many ways we are in a stronger position now than ever before to complete a project of this magnitude.

14) Why build a bigger building instead of planting a church or churches?

We believe this is a 50-year decision that will maximize the footprint that God has given FBCN and will maintain a strong Gospel-Centered, Bible preaching church in Newcastle for decades to come.

While church planting may be an option in the future, we don't believe Newcastle and the surrounding population density supports planting churches in our area at this time. We foresee that changing over the next 10-20 years.

This decision puts FBCN in the best position possible for reaching future generations.



CONTINUE THE LIVING THE VISION JOURNEY AT:

fbcnewcastle.com/LTV

